

NITECORE®

奈特科尔—全能照明专家

LR30 营地灯 使用说明书

产品特性

- 红白双光源营地灯
- 使用6颗高显色性LED (CRI ≥ 90), 1颗红光LED
- 两种模式: 白光模式 (3档调节) 和红光模式 (红光照明/警示红闪/SOS)
- 使用1节18650锂电池供电, 兼容2节CR123或RCR123电池
- 单键开关设计, 单手即可操作
- 采用高光效的PC光扩散材料, 散发均匀、柔和的光效
- 开关按键内藏电量指示灯, 可提示电池剩余电量
- 定位提示功能
- 高效率恒流电路, 亮度恒定
- 电子防反接设计
- 底部磁铁吸附功能
- 灯体采用PC材料制造, 坚固耐用
- IPX6防水等级
- 1米防跌高度

体积

尺寸: 92mm × 43.5mm × 31.6mm
重量: 62克 (不含电池)

配件

防水圈

选用电池

	尺寸规格	标称电压	是否可用
18650锂电充电电池	18650	3.7V	推荐
一次性锂金属电池*	CR123	3V	是
可充电锂离子电池*	RCR123	3.7V	是

亮度&时间

	高亮	中亮	任务	红光	警示慢闪	SOS
亮度	205流明	85流明	12流明	45流明	45流明	45流明
续航时间 1 x 18650	*3小时 30分钟	8小时 30分钟	62小时	8小时	—	—
续航时间 2 x CR123	*2小时 30分钟	6小时	46小时	5小时 30分钟	—	—
照明直径	40米	20米	9.8米	12米	—	—
光强	103坎德拉	24坎德拉	6坎德拉	9坎德拉	—	—
防跌落高度	1米					
防护等级	IPX6					

注: 上述数据以1节18650锂电池 (3.7V 3400mAh) 和两节CR123 (3V 约1700mAh) 分别测量所得, 不同电池或使用环境可能会对以上数据产生影响。

* 高亮档位续航时间包含了亮度自动调整后的照明时间。

使用LR30营地灯

装入电池

如图所示, 按照正负方向放入一节18650或两节CR123/RCR123电池。
注: 在每次装入电池后, 按钮开关的电量指示灯将以闪烁的方式报出电池剩余电量。详情请参考“电量提示”一章。

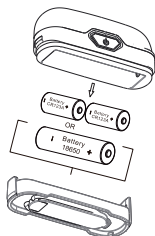

开启/关闭

长按开关按钮0.6秒以上, 营地灯开启; 如需关闭, 请再次长按开关0.6秒。

亮度调节

在营地灯开启状态下, 每次按开关按钮, 营地灯按照: 低亮→中亮→高亮, 顺序循环切换。
注: LR30在开启高亮档位10分钟后自动降低亮度输出以防止过热, 并有效地保障电池的使用寿命。

使用红光 (红光照明/警示慢闪/SOS)

在营地灯关闭状态下, 双击开关按钮, 红光照明开启。此时每次单击开关, LR30按照: 警示慢闪→SOS→红光照明, 顺序循环切换, 如需关闭, 长按开关按钮0.6秒以上。

电量提示

每次装入电池时, 位于开关附近的蓝色电量指示灯将以闪烁来表示电池电压 (精确到 ± 0.1V)。例如: 电池电压为4.2V时, 指示灯将闪烁4次, 停顿1.5秒后再闪烁2次来表示4.2V。所提示的电压表示电池电量详见下图:

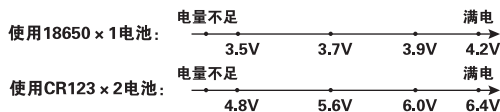

定位提示功能

在营地灯开启状态下, 长按开关按钮3秒后, 营地灯退出照明并进入定位提示功能。蓝色电量指示灯将每2秒闪烁一次以提示用户LR30的位置。在定位提示灯状态下, 1节18650电池约可待机超过半年时间; 而在普通待机状态下, 1节18650电池约可待机超过一年时间。

更换电池

当电池电量不足, LR30会出现亮度变暗或者无法调光的情况。此时, 应更换电池或进行充电。

注意事项

1. 请勿将电池反接, 否则营地灯将无法工作。
2. 请使用优质电池, 当长期不用营地灯时将电池从营地灯中取出, 否则可能因部分品质不良的电池漏液或者爆炸, 造成电筒损坏。
3. 请勿用眼睛直视营地灯, 以免对眼睛造成伤害。
4. 本产品包装含零散小部件, 请勿在儿童可触及的地方, 以防误食。
5. 请勿随意拆解、改装本产品, 否则将会导致保修失效并可能损坏营地灯。
6. 在续航过程中, 当电池电量少于10%时, LR30只保留低亮档位, 其余档位均不可用。

保固

NITECORE®产品拥有售后保固服务。在购买本产品的15天内, 如果有任何质量问题均可向经销商要求免费更换。在购买本产品的5年内享受免费保固服务。在超过5年免费保固期后, 本产品享有终身有限度保固服务, 如需要更换重要部件则需收取成本费用。

本保固规则不适用于以下情况:

1. 人为破坏, 拆解, 改装本产品。
2. 错误操作导致产品损坏(如装反电池等)。
3. 电池漏液导致产品损坏。

如对奈特科尔产品有任何疑问, 欢迎联系当地的代理商或发邮件到4008869828@nitecore.cn
※ 本说明书的所有图片、陈述及文字信息仅供参考, 请以官网www.nitecore.cn实际信息为准。广州希脉创新科技有限公司拥有对说明书内容的最终解释权 and 修改权。

更多信息请关注新浪微博:
NITECORE奈特科尔

广州希脉创新科技有限公司

咨询热线: +86-20-83862000

销售邮箱: info@nitecore.com

网址: www.nitecore.cn

地址: 广州市天河区珠江新城洗村路5号凯华国际中心2601-06室

邮编: 510623



1028120201

400客户服务热线: 400-886-9828 感谢您购买我们的产品!

Features

- White/red dual light sources
- Utilises 6 high performance white LEDs and a red LED
- Dual lighting modes: White illumination (3 adjustable brightness) and red illumination (Includes constant, blinking and SOS)
- Powered by a single 18650 or 2 x CR123 or 2 x RCR123 batteries
- Single switch design offers easy one handed operations
- Takes advantages of highly translucent diffuser, allowing all light source to be well distributed
- Built-in power indicator reports remaining battery power
- Built-in power indicator doubles as positioning medium
- High efficiency constant current circuit
- Electrical reverse polarity protection
- Magnetic base
- Made from durable PC materials
- Waterproof in accordance with IPX6
- Impact resistant to 1 metre

Dimensions

Size: 3.62" × 1.72" × 1.24"

Weight: 2.18oz (62gram) (without battery)

Accessories

Waterproof ring

Battery Options

	TYPE	Nominal voltage	Compatible
18650 Rechargeable Li-ion battery	18650	3.7V	Yes (Recommended)
Primary Lithium battery *	CR123	3V	Yes
Rechargeable Li-ion battery *	RCR123	3.7V	Yes

Output & Runtime

Output	HIGH	MID	LOW	RED	Red Flashing	SOS
	205 LUMENS	85 LUMENS	12 LUMENS	45 LUMENS	45 LUMENS	45 LUMENS
Runtime 1x18650	*3h30min	8h30min	62h	8h	—	—
Runtime 2xCR123	*2h30min	6h	46h	5h30min	—	—
Beam Diameter	40m	20m	9.8m	12m	—	—
Beam Intensity	103cd	24cd	6cd	9cd	—	—
Impact Resistance	1m					
Waterproof	IPX6					

NOTICE:

The stated data has been measured with 1 x 18650 battery (3.7V, 3400mAh) or 2 x CR123 batteries (3V, 1700mAh) under laboratory conditions. The data may vary in real-world use due to different battery use or environmental conditions.

*The runtime for "High" measured in the chart includes the runtime for when brightness is adjusted from "High" to prevent overheating.

Operating Instructions

Battery installation

Insert one 18650 or two CR123/RCR123 batteries with polarities pointing toward the right direction, as marked inside the battery compartment.

Note: Upon battery installation, the built-in power indicator will blink to report battery power, for more information, please refer to the "Power Tips" section.

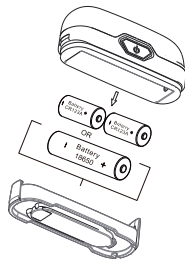

ON/OFF

Hold down the power button to switch the light on, hold down the button again to switch it off.

Brightness Adjustment

With the light turned on, tap the power button repeatedly to cycle through Low-Mid-High.

Note: The LR30 will automatically lower its output from "High" after 10 minutes to prevent overheating and extend battery life.

Red Lighting (Red Illumination/Red Flashing/SOS)

With the light turned off, press the power button twice to turn the red LED on, press the power button to cycle through Red Flashing-SOS-Red Illumination.

Power Tips

Upon battery installation, the built-in power indicator will blink to report battery voltage (accurate to 0.1V). For instance, when battery voltage is measured at 4.2V, the power indicator will blink 4 times followed by a short pause, then another 2 blinks.

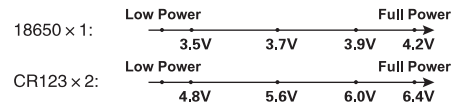

Positioning

With the light turned on, hold down the power button for 3 second turns the light off, which in turn activates the power indicator to blink once every 2 seconds, this serves to remind users the location of the LR30. With a fully charged 18650, the LR30 will remain operational for 6 months with the power indicator activated, and 12 months in standby with the power indicator deactivated.

Precautions

1. DO NOT insert batteries backward, doing so renders the product inoperative.
2. Always use quality batteries, and remove batteries from the product when it will be left unattended for extensive period.
3. Avoid direct eye exposure
4. DO NOT disassemble, modify the product, it may damage the product and void its product warranty
5. All modes will be inoperative with the exception of "Low" when battery level drops below 10%.

Replacing Batteries

Batteries should be replaced when output appears to be dim and unresponsive, or when the power indicator is blinking rapidly.

Warranty Details

Our authorized dealers and distributors are responsible for warranty service. Should any problem covered under warranty occurs, customers can contact their dealers or distributors in regards to their warranty claims, as long as the product was purchased from an authorized dealer or distributor. NITECORE's Warranty is provided only for products purchased from an authorized source. This applies to all NITECORE products.

Any DOA / defective product can be exchanged for a replacement through a local distributor/dealer within the 15 days of purchase. After 15 days, all defective / malfunctioning NITECORE® products can be repaired free of charge for a period of 60 months (5 years) from the date of purchase. Beyond 60 months (5 years), a limited warranty applies, covering the cost of labor and maintenance, but not the cost of accessories or replacement parts.

The warranty is nullified if the product(s) is/are broken down, reconstructed and/or modified by unauthorized parties, or damaged by batteries leakage.

For the latest information on NITECORE® products and services, please contact a local NITECORE® distributor or send an email to service@nitecore.com.

※ All images, text and statements specified herein this user manual are for reference purpose only. Should any discrepancy occurs between this manual and information specified on www.nitecore.com. SYSMAX Innovations Co., Ltd. reserves the rights to interpret and amend the content of this document at any time without prior notice.



SYSMAX Innovations Co., Ltd.

TEL: +86-20-83862000

FAX: +86-20-83882723

E-mail: info@nitecore.com

Web: www.nitecore.com

Address: Rm 2601-06, Central Tower, No.5 Xiancun Road, Tianhe District, Guangzhou, 510623, Guangdong, China



LR30123021

Made in China

Thanks for purchasing NITECORE!